

**EXCELON<sup>®</sup> PRO**  
Lockout/shut-off valve  
ø 6 to 12 mm, G 1/8 to G 3/8

**Easy to order**  
**Configuration flexibility**  
**Excellent value**  
**No tools required for assembly**  
**RoHS compliant**

**Technical data**

Medium:  
Compressed air  
Operating pressure:  
12 bar max.  
Flow:  
CV = 2,57 (G 1/4)  
Ambient temperature:  
-20°C\* to +60°C  
\* Consult our Technical Service for use below +2°C

**Ordering information**

See page 2

**Materials:**

Body and valve stem: PBT  
Internal parts: Acetal  
Elastomers: Nitrile and TPE

**Standard model**

Port size	Model	Flow (Cv factor)	Weight kg
G 1/4	T92T-2GN-B1N	2,57	0,16

**Ordering example**

Lockout/shut off valve - G 1/4 with mounting bracket  
 3-port/2-position with threaded exhaust port.  
 Quote: T92T-2GN-B1N

**Options selector**

T92★-★★N-B1N

Function	Substitute
2-port/2-position, non exhaust outlet, black slide	B
3-port/2-position, threaded (M5) exhaust outlet, red slide	T

Connector with mounting bracket	Substitute
6 mm Push-In fitting	6D
8 mm Push-In fitting	8D
10 mm Push-In fitting	AD
12 mm Push-In fitting	BD
G 1/8	1G
G 1/4	2G
G 3/8	3G



  

Connector without mounting bracket	Substitute
G 1/4	2V

  

Connector	Substitute
Without	NN

**Component parts and accessories**

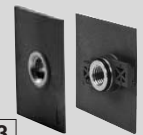
	Push-in fitting connector with mounting bracket	Threaded connector with mounting bracket	Threaded connector without mounting bracket
			
	<b>1</b>	<b>2</b>	<b>3</b>
<b>Port size</b>			
G1/8	-	9212KIT-1G	-
G1/4	-	9212KIT-2G	9211KIT-2V
G3/8	-	9212KIT-3G	-
ø 6 mm	9213KIT-6D	-	-
ø 8 mm	9213KIT-8D	-	-
ø 10 mm	9213KIT-AD	-	-
ø 12 mm	9213KIT-BD	-	-

Locking plate front plate of	Silencer
	
<b>7</b>	<b>9</b>
9236-88/X10 (quantity 10)	T40M0500

 **Warning**  
Locking plates **MUST** be in place before pressurizing any Excelon Pro unit.

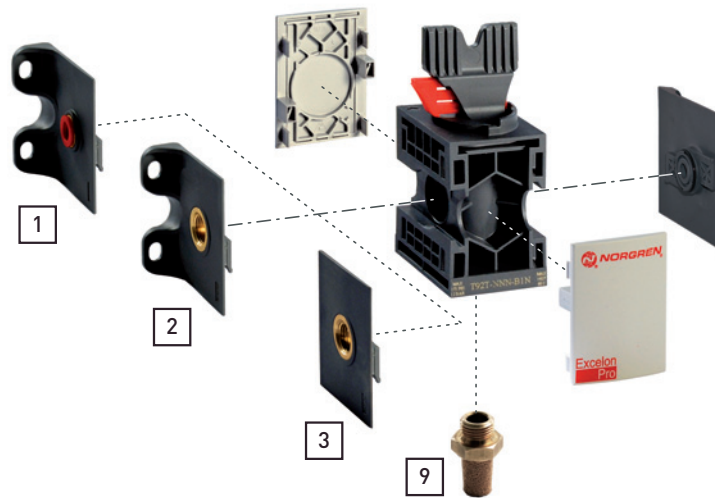

**Shut-off valve with wall mounting bracket**

**Shut-off valve without mounting bracket**

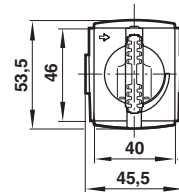
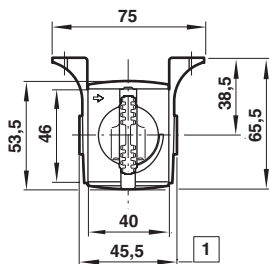
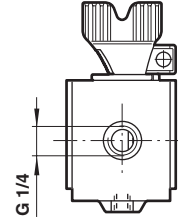
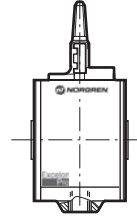
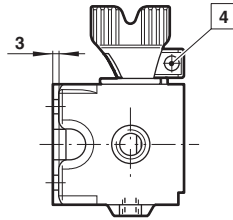
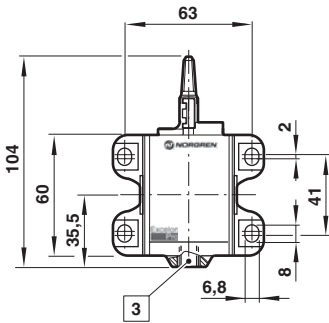

- 1 Connector Dimensions**  
1/8" and 1/4" threaded connectors shown. See below for port-to-port dimensions for additional connectors.

<b>PIF Connector</b>	<b>Port-to-port</b>
6 mm, 8 mm	60
10 mm, 12 mm	62
<b>Threaded connector</b>	
1/8", 1/4"	45,5
3/8"	76

- 3 M5 exhaust port**
- 4 Lever lockable only in closed position. Lock slide accepts  $\varnothing$  7 mm padlock/shackle.**

**Warning**

These products are intended for use in industrial compressed air systems only. Do not use these products where pressures and temperatures can exceed those listed under **'Technical Data'**.

Before using these products with fluids other than those specified, for non-industrial applications, life-support systems, or other applications not within published specifications, consult NORGREN.

Through misuse, age, or malfunction, components used in fluid power systems can fail in various modes.

The system designer is warned to consider the failure modes of all component parts used in fluid power systems and to provide adequate safeguards to prevent personal injury or damage to equipment in the event of such failure.

**System designers must provide a warning to end users in the system instructional manual if protection against a failure mode cannot be adequately provided.**

System designers and end users are cautioned to review specific warnings found in instruction sheets packed and shipped with these products.