

**3/2, 5/2 and 5/3 directional control valves**  
**Actuation: electromagnetic**  
**Indirectly controlled soft seal spool valves**  
**Port size: G 1/4, G 1/2**

- Straight-through flow, high Cv-factor**
- Compact design**
- Maintenance-free**
- Easy to service**
- Easily interchangeable solenoid system**
- Standard manual override**
- The valves and solenoids are ATEX approved**



### Technical data

- Operating medium:  
Solenoid valve for filtered, lubricated \*1)  
or non-lubricated air
- Operation:  
Solenoid, indirectly controlled
- Flow direction:  
Fixed
- Mounting position:  
Optional
- Nominal size:  
6 and 12 mm
- Port size:  
G 1/4, G 1/2
- Electrical connection:  
Connector interface to DIN EN 175301-803  
form A and B
- Operating pressure:  
1 to 10 bar
- Temperature:  
-10 ... 50°C  
Please consult our technical service for use below +2°C. If installed  
in the open protect all connections against the penetration of moisture!

### Material:

- Housing: Aluminium
- Pilot flange: Plastic
- Seat seal: NBR (Perbunan)

\*1) Oil recommendation: Shell Hydrol DO 32, Esso Febis (as of July 1992)  
or comparable oils with DVI values < 8 (DIN 53521) and ISO viscosity class  
32-46 (DIN 51519).

### Ordering information

See page 2

### Further versions

NPT

### Accessories

- Manifold system
- Connectors

### data sheet

7503364  
N/UK 7.7.002

### 3/2

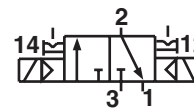
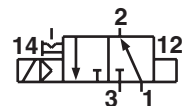
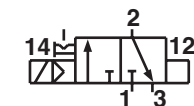

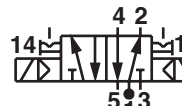
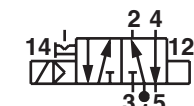

### 5/2

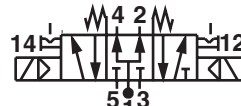
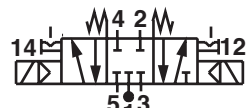
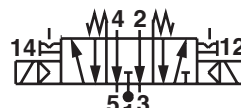

### 5/3

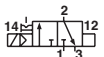
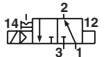
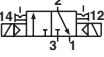
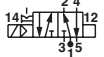
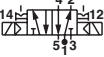
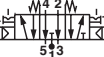
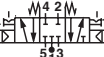
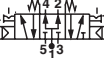
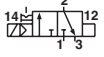

## General information

Symbol	Type*	Function	Port size	Nominal size	Operating pressure (bar)		Flow (l/min)	Power drawn (W)	Weight (kg)	Dimensions Nr.
					Min.	Max.				
	8010750 *2)	3/2 mono NC	G 1/4	6	1,0	10 *3)	1200	< 5	0,4	1
	8010850 *2)	3/2 mono NC	G 1/2	12	1,5	10 *3)	3000	< 5	0,7	2
	8012750 *2)	3/2 mono NO	G 1/4	6	1,0	10 *3)	1200	< 5	0,4	1
	8012850 *2)	3/2 mono NO	G 1/2	12	1,5	10 *3)	3000	< 5	0,7	2
	8011750	3/2 bi	G 1/4	6	1,0	10	1200	< 5	0,77	3
	2623000 *2)	5/2 mono	G 1/4	6	1	10 *3)	1200	< 5	0,4	5
	2623500 *2)	5/2 mono	G 1/2	12	2	10 *3)	3000	< 5	0,7	6
	2623100	5/2 bi	G 1/4	6	1	10	1200	< 5	0,4	7
	2623600	5/2 bi	G 1/2	12	2	10	3000	< 5	0,7	8
	2623200	5/3	G 1/4	6	3	10	900	< 5	1,0	9
	2623700	5/3	G 1/2	12	2,5	10	2200	< 5	1,6	10
	2623300	5/3	G 1/4	6	3	10	900	< 5	1,0	9
	2623800	5/3	G 1/2	12	2,5	10	2200	< 5	1,6	10
	2623400	5/3	G 1/4	6	3	10	900	< 5	1,0	9
	8010751 *2)	3/2 mono NC	G 1/4	6	2	8 *3)	1200	< 2	0,4	1
	8010851 *2)	3/2 mono NC	G 1/2	12	2	8 *3)	3000	< 2	0,7	2
	2623001 *2)	5/2 mono	G 1/4	6	2	8 *3)	1200	< 2	0,4	5
	2623501 *2)	5/2 mono	G 1/2	12	2	8 *3)	3000	< 2	0,7	6
	2623101	5/2 bi	G 1/4	6	2	8	1200	< 2	0,4	7
	2623601	5/2 bi	G 1/2	12	2	8	3000	< 2	0,7	8

All types with manual override

\* When ordering please indicate solenoid, voltage and current type (frequency).

\*2) Port 3 is not throttleable

\*3) Stagnation pressure at R Á operating pressure -1 bar

## Ordering information

3/2 directional control valve, connection G 1/4,  
actuating solenoid 24 V DC, with connector DIN 43650 form B,  
protection class IP65

**Part No.: 8010750.3053.024.00**

## Warning

These products are intended for use in industrial compressed air systems only. Do not use these products where pressures and temperatures can exceed those listed under 'Technical Data'.

Before using these products with fluids other than those specified, for non-industrial applications, life-support systems, or other applications not within published specifications, consult NORGREN.



Through misuse, age, or malfunction, components used in fluid power systems can fail in various modes. The system designer is warned to consider the failure modes of all component parts used in fluid power

systems and to provide adequate safeguards to prevent personal injury or damage to equipment in the event of such failure.

**System designers must provide a warning to end users in the system instructional manual if protection against a failure mode cannot be adequately provided.**

System designers and end users are cautioned to review specific warnings found in instruction sheets packed and shipped with these products where applicable.

**Solenoid actuators**

Type	Power consumption		Rated current at		Protection class Fluid max.	Temperature Ambient/fluid (°C)	Weight (kg)	Dimensions No.	Circuit diagram No.	
	24 V DC (W)	230 V AC (VA)	24 V DC (mA)	230 V AC (mA)						
	3052	4,8	8,5	–	–	IP 00 without connector, IP 65 with connector* Form B *6)	-40 ... +50	0,06	11	1
	3050	1,7	4,3	–	–					
	3030	4,5	8,0	–	–	IP 00 without connector, IP 65 with connector* Form A *6)	-40 ... +50	0,09	12	1
	3036	1,6	3,5	–	–					
	3062	2,7	–	–	–	Cat. II2G, EEx m II T5 3 m cable *2)	-20 ... +50	0,13	13	1
	3063	–	2,1	–	–					
	3060	5,0	–	–	–					
	3061	–	5,0	–	–					

\* Connector not supplied, Order No.: form A 0570275, form B 0680003, DIN EN 1753301-803  
 \*2) Certificate of Conformity PTB No. 03 ATEX 2015 X  
 Valves and solenoids can only be combined if their electrical ratings correspond with each other (see table »General information«).  
 For valve with power consumption < 5 watt please use 4,8 or 4,5 watt solenoids.  
 For valve with power consumption < 2 watt please use 1,7 or 1,6 watt solenoids.  
 Standard voltages 24 V DC, 230 V AC. Further versions on request.

**Accessories**

**Connectors**

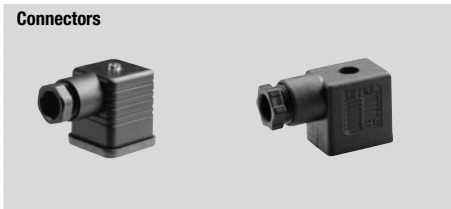

0570275 form A

0680003 form B

Basic dimensions for valves

①, ②

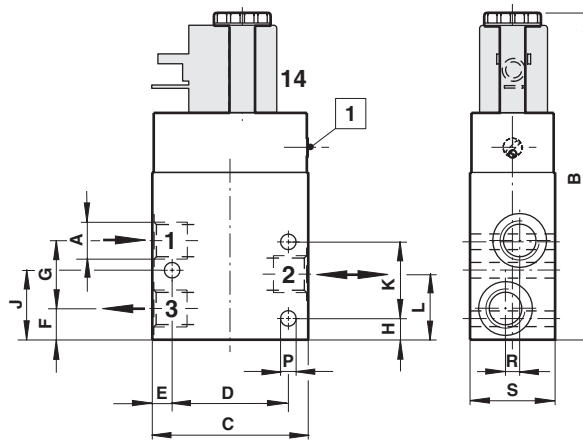

1 Manual override

Dimensional drawing No.	A	B	C	D	E	F	G	H	J	K	L	ØP	R	S
1	G 1/4	115,5	55	41	7	11	24	7,5	24,5	27	23	5,5	5	30
2	G 1/2	143,5	65	46	9,5	29	33	31,5	-	46	50	7	2,5	35

③, ④

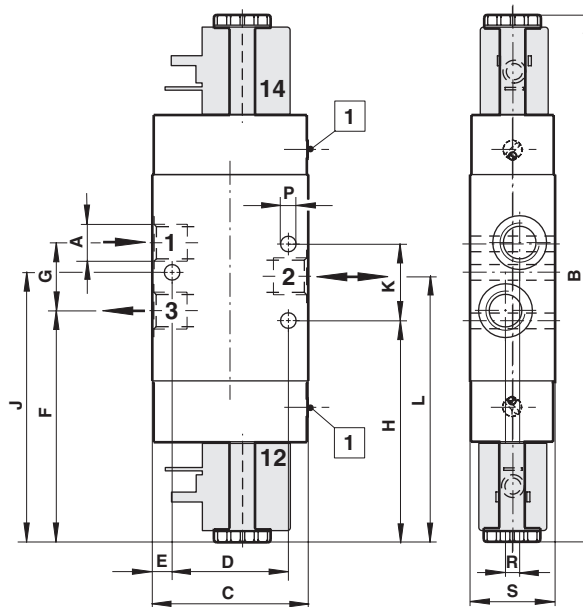

1 Manual override

Dimensional drawing No.	A	B	C	D	E	F	G	H	J	K	L	ØP	R	S
3	G 1/4	186,5	55	41	7	81,5	24	78	95	27	93,5	5,5	5	30
4	G 1/2	195,5	65	46	9,5	81	33	81	-	46	100,5	7	2,5	35

**Basic dimensions for valves**

⑤, ⑥

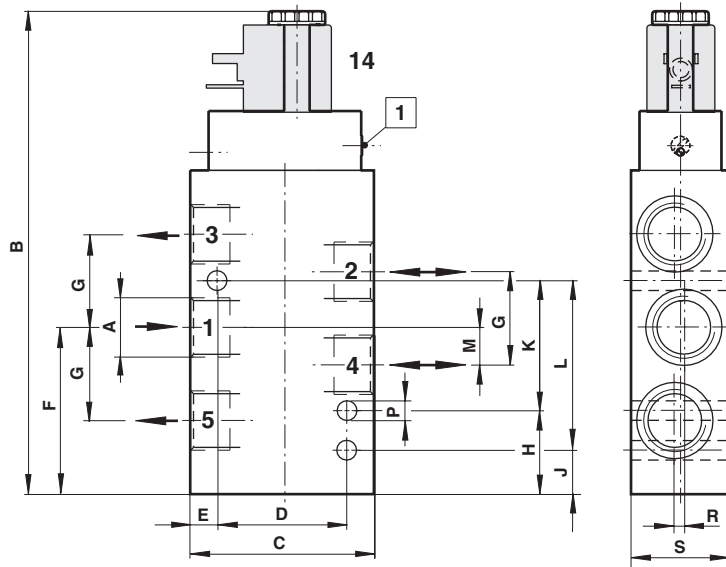

1 Manual override

Dimensional drawing No.	A	B	C	D	E	F	G	H	J	K	L	M	Ø P	R	S
5	G 1/4	139,5	55	40	7,5	35	24	—	5	—	67	12	7	5	30
6	G 1/2	171,5	65	46	9,5	59,5	33	30	16	46	60	13	7	3	35

⑦ to ⑩

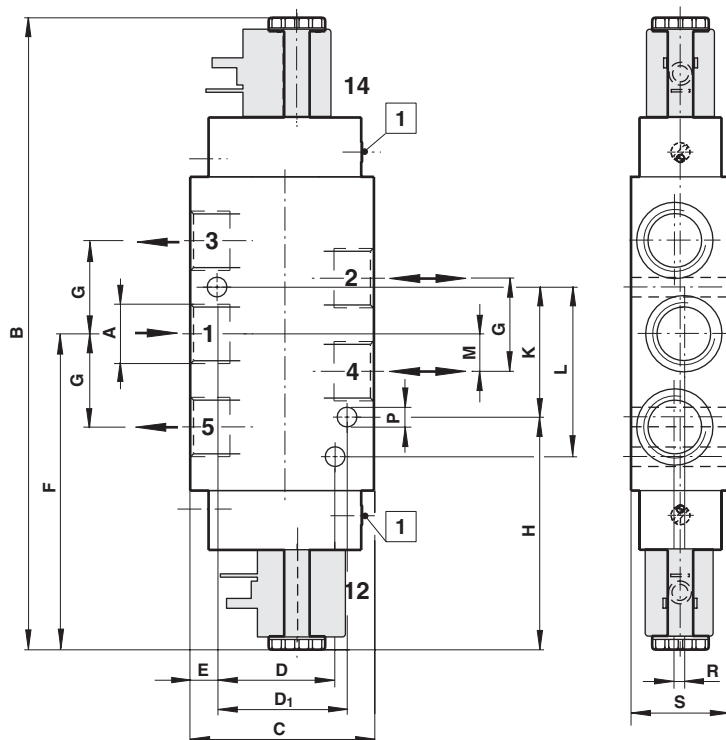

1 Manual override

Dimensional drawing No.	A	B	C	D	D1	E	F	G	H	K	L	M	Ø P	R	S
7	G 1/4	214,5	55	40	40	7,5	107,5	24	77,5	67	—	12	7	5	30
8	G 1/2	223,5	65	46	46	9,5	112	33	82,5	46	60	13	7	3	35
9	G 1/4	232,5	55	40	40	7,5	118	24	88	67	—	12	7	5	30
10	G 1/2	289	70	46	50	10	144,5	33	—	50	60	16,5	7	4	40

Basic dimensions for solenoid operators

⑪

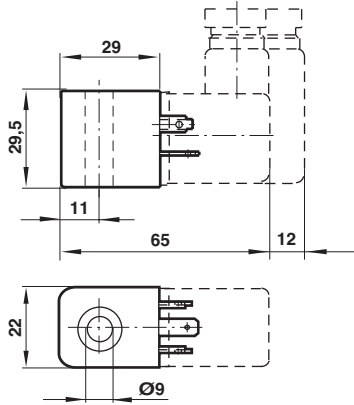

⑫

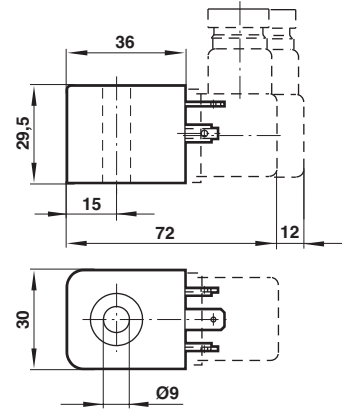

⑬

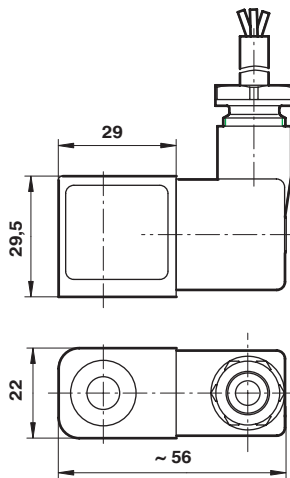

1 Solenoid actuators  
4x90° turnable

Circuit diagrams

①

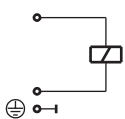

⑧

